

KEYNOTES

- 1 ACCESS LADDER TO CONCRETE ROOF OF ELECTRICAL ROOM - SEE ENLARGED PLANS.
2 3'-0" X 3'-0" ROOF HATCH WITH ACCESS LADDER FROM CONCRETE ROOF AT ELECTRICAL ROOM BELOW, G.C. TO COORDINATE WITH STRUCTURE. PAINTED SAFETY YELLOW - SEE ENLARGED PLANS AND ROOF PLAN.
3 RIDGELINE
4 ELECTRICAL ROOM - 1 HOUR RATED
5 FIRE PUMP ROOM - 1 HOUR RATED
6 RAMP GUARDRAIL - SEE DETAILS 4, 12 & 13 ON A.101
7 5' X 5' CONCRETE PAD, SLOPE AWAY FROM BUILDING AT 1/4" PER FT. MAX.
8 9" X 9" 24 GAUGE METAL DOWNSPOUTS WITH KYNAR FINISH
9 BRACING DOWN TO 14' A.F.F. - SEE STRUCTURAL
10 FUTURE ACCESS RAMP

GENERAL NOTES

- 1. BUILDING TO BE 36' CLEAR JUST PAST THE FIRST COLUMN LINE IN FROM THE DOCK WALL.
2. SLAB CONTROL JOINTS TO BE SAWCUT AND NOT TO EXCEED 15'-0" ON CENTER. SEE STRUCTURAL DRAWINGS FOR FLOOR SLAB CONTROL JOINTS.
3. SLAB CONSTRUCTION JOINTS TO HAVE SMOOTH DOWELS AT 24" O.C. OR STEEL DIAMOND PLATES - SEE STRUCTURAL DRAWINGS.
4. SLAB WILL BE CURED WITH A WATER-BASED DISSIPATIVE CURING COMPOUND AND WILL RECEIVE TWO COATS OF ASHFORD FORMULA FLOOR HARDENER.
5. SLAB ON GRADE WILL BE PRE-TREATED WITH TERMITICIDE.
6. 10-MIL VAPOR BARRIER TO BE PROVIDED BELOW THE SLAB ON GRADE THROUGHOUT. ALL SEAMS AND PENETRATIONS TO BE SEALED AND TAPED.
7. 7" THICK REINFORCED 4,000 PSI CONCRETE SLAB BEARING ON COMPACTED SUBGRADE. SLAB TO RECEIVE HARD TROWEL FINISH AND LASER SCREED SHALL BE UTILIZED TO ATTAIN MINIMUM LOCAL & OVERALL SLAB TOLERANCE OF FF 40/FL 30.
8. PROVIDE A ESFR SPRINKLER SYSTEM THROUGHOUT.
9. PROVIDE PORTABLE FIRE EXTINGUISHERS OF THE QUANTITY AND AT THE LOCATIONS AS INDICATED OR AS REQUIRED BY THE AUTHORITY HAVING JURISDICTION. EXTINGUISHERS SHALL BE EQUAL TO J.L. INDUSTRIES COSMIC 10E, 10 POUND, 4A-60BC, TO BE COORDINATED WITH OWNERS LAYOUT.
10. FLORIDA APPROVED METAL ROOF DECK SHALL BE 1-1/2" TYPE "B" WIDE RIB DECKING SHOP PRIMED WHITE - SEE STRUCTURAL DRAWINGS.
11. RACKING, FLOOR STORAGE AND EQUIPMENT BY OTHERS.
12. SEE ELEVATIONS FOR GLASS SCHEDULE.
13. ALL BOLLARDS TO BE PAINTED SAFETY YELLOW. (PROVIDE BOLLARDS AT ALL DRIVE-IN OVERHEAD DOOR JAMBS, FIRE PROTECTION RISERS, ELECTRICAL TRANSFORMERS AND EXPOSED ELECTRICAL PANELS).
14. ALL BOLLARDS SHALL BE 6" O.D. SCHEDULE 80 STEEL PIPE SET MINIMUM 2'-0" DEEP IN 2'-0" DIAMETER CONCRETE FOOTING WITH PIPE EXTENDED 4'-0" ABOVE PAVING OR FLOOR. FILL PIPE WITH CONCRETE AND CAP WITH PRECAST CONCRETE DOME TOP - FOOTING TO BE IN SONOTUBE.
15. FLORIDA APPROVED ROOF ASSEMBLY: SINGLE PLY 45 MIL WHITE TPO MEMBRANE SYSTEM MECHANICALLY FASTENED OVER R-20 ROOF INSULATION OVER 1-1/2" METAL DECK, 10-YEAR NDL WARRANTY, R-25 OVER OFFICE AREA.
16. ALL STAIRS AND RAILINGS TO BE GALVANIZED. ALL MISC. STEEL TO BE HD GALVANIZED FOR EXTERIOR APPLICATIONS.
17. ALL SITE CAST CONCRETE PANEL WIDTHS ARE TO CENTERLINE OF CONCRETE PANEL VERTICAL JOINT U.N.O.
18. ALL TILT WALL PANELS SHALL BE CAULKED TO FULL HEIGHT, BOTH SIDES, WITH MASTERSEAL NP-2 POLYURETHANE SEALANT OR EQUAL WITH BACKER ROD BEHIND THE CAULK.
19. EXTERIOR ALL S.C.C.P. SHALL RECEIVE A TEXTURED ACRYLIC COATING SIMILAR TO SHERWIN WILLIAMS ULTRACRETE (MEDIUM TEXTURE) WITH ACCENT STRIPING - SEE ELEVATIONS.
20. (INTERIOR) ALL S.C.C.P. PANELS WILL BE HARD TROWEL FINISHED WITH CAPPED PICK AND BRACE POINTS.
21. FLORIDA APPROVED PERSONNEL DOORS AND MISC. METALS SHALL RECEIVE ONE (1) PRIMER COAT AND ONE (1) FINISH COAT OF ENAMEL. PROVIDE FIRE DEPARTMENT ACCESS SIGNAGE PER DETAIL 3/A.109 AT EACH PERSONNEL DOOR.
22. TEST AND CONFIRM COMPLIANCE WITH THE INTERNATIONAL FIRE CODE SECTION 510 FOR EMERGENCY RESPONDER RADIO COVERAGE. IF REQUIRED BY TEST, PROVIDE AND INSTALL AN APPROVED SYSTEM BY A FCC LICENSED RADIO CONTRACTOR.

FILE PATH: C:\Users\Nikhil\OneDrive\Documents\2101066_Commonwealth Bldg_2_R21_maho\22SZ.rvt

KEYNOTES

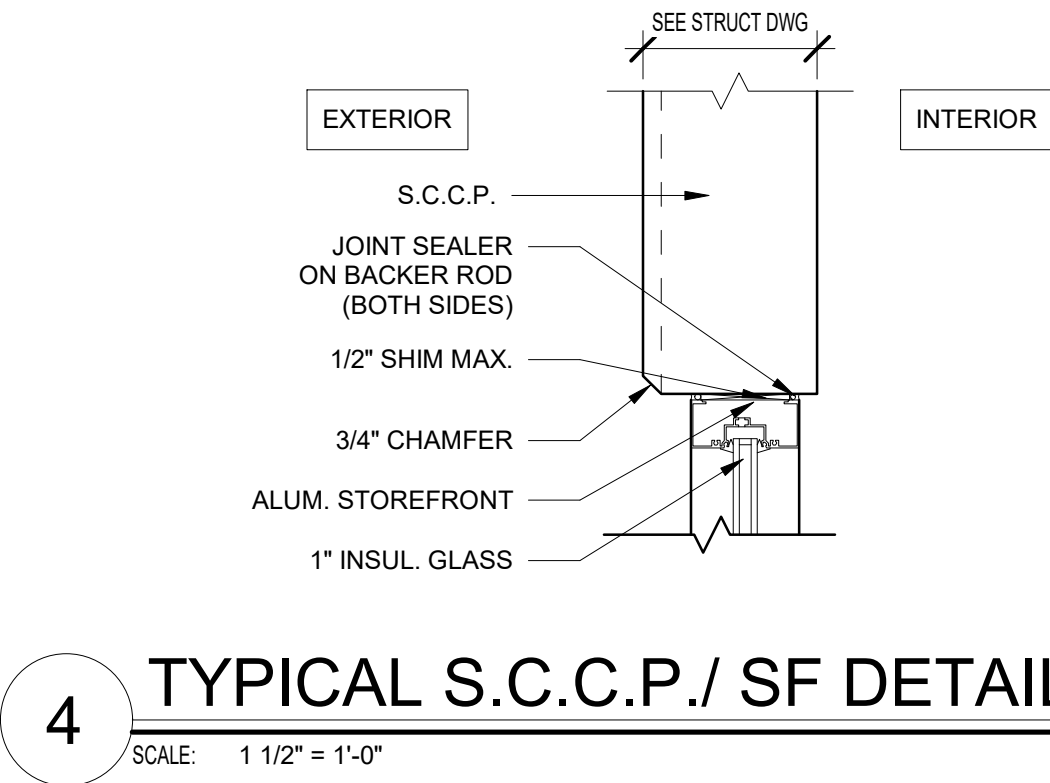

4 TYPICAL S.C.C.P./ SF DETAIL
SCALE: 1 1/2" = 1'-0"

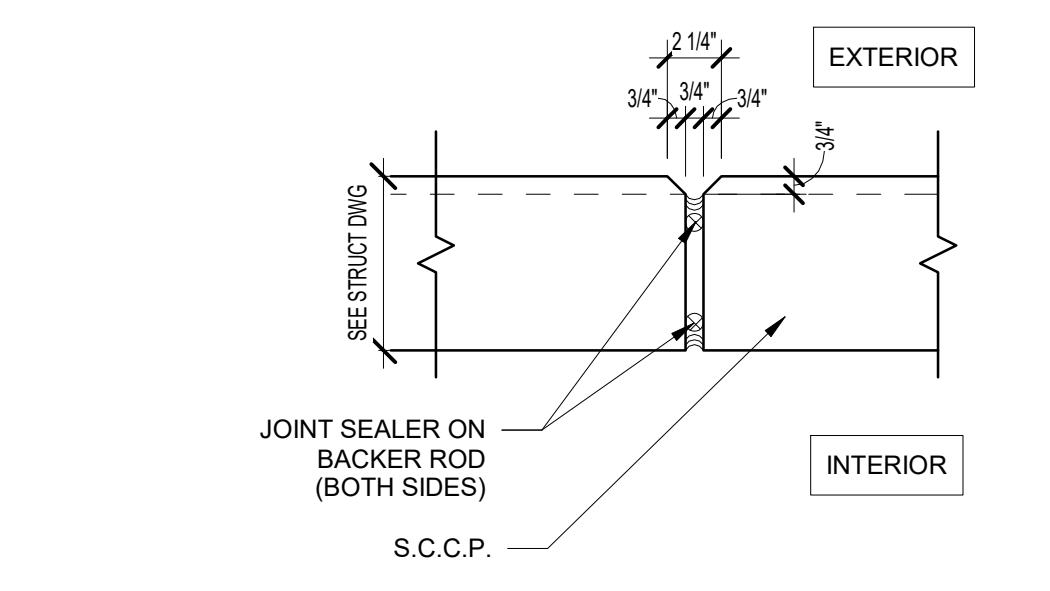

3 TYPICAL S.C.C.P. JOINT DETAIL
SCALE: 1 1/2" = 1'-0"

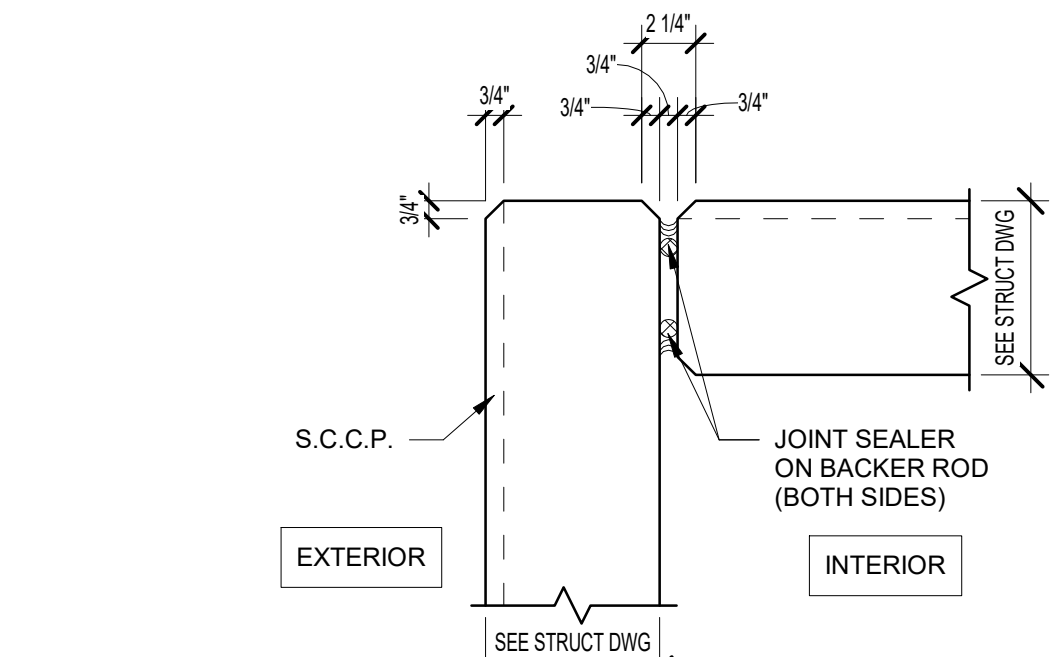

2 TYPICAL S.C.C.P. CORNER DETAIL
SCALE: 1 1/2" = 1'-0"

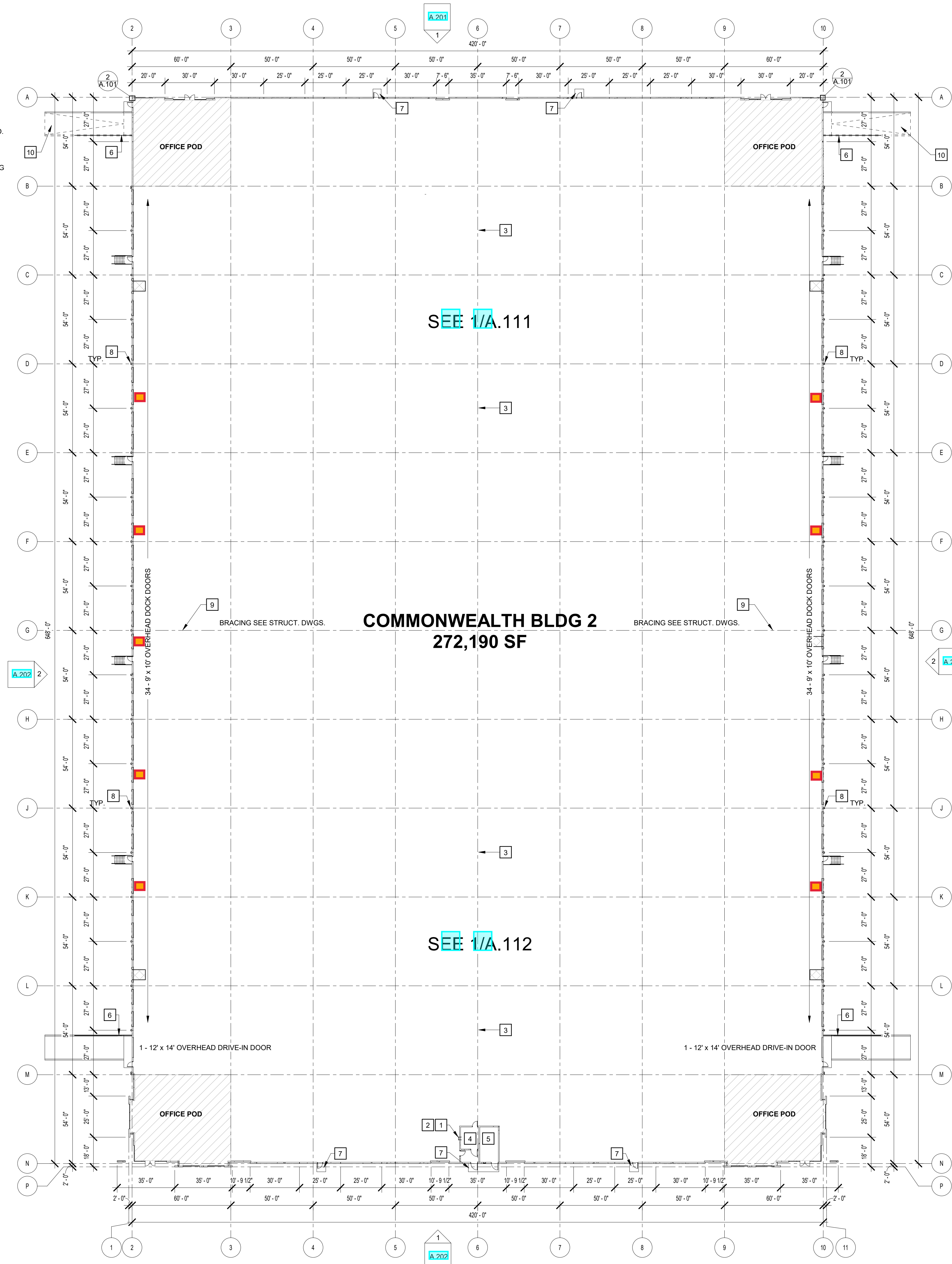

1 OVERALL FLOOR PLAN
SCALE: 1/32" = 1'-0"

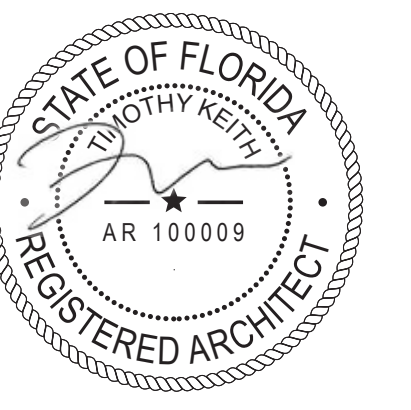

COMMONWEALTH

BUILDING 2

1700 IMESON ROAD
JACKSONVILLE, FL 32220

©2022, Atlas Collaborative LLC. These drawings are protected by the copyright laws of the United States. These drawings or any part thereof may not be used for any purpose or reproduced in any form or by any means without the written consent of Atlas Collaborative, LLC.

Print Record

Table with columns for date and description, listing design reviews and check set dates from 2021 to 2022.

Revisions

Table for revisions with columns for description and date, currently empty.

Issue Date: 03/04/2022 Job No: 2101096

Sheet Title

OVERALL FLOOR PLAN

Sheet No.

A.101

ISSUED FOR CONSTRUCTION

